

BRExhaust™

A  MAGNAFLOW GROUP COMPANY

INSTALLATION INSTRUCTIONS | PART NO. 106-0751

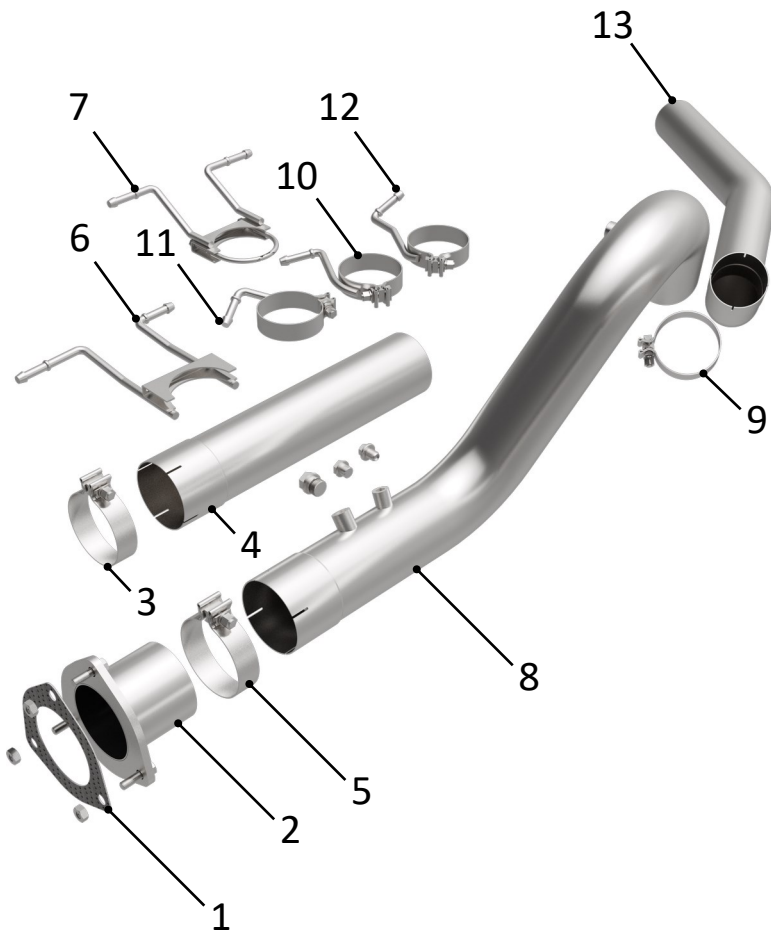

STEP 1: (Carefully read all instructions before installation) Disconnect the vehicle's battery before removal of the OEM exhaust system. This will prevent electrical accidents and will reset the computer if it applies to the vehicle. Remove existing exhaust system from the vehicle. Only remove parts that will be replaced. Clean existing flange with a wire brush to ensure proper sealing.

STEP 2: For 2014 and up you may need to cut the piping of your OE exhaust system before installation. Refer to [Table 1](#) on [Page 2](#) of this document. Measurements are to be made rearward of the DPF beginning from the DPF rear weld junction. Refer to [Table 2](#) on [Page 2](#) of this document for clamp and year range usage.

STEP 3: For 2007.5-2013 attach [\[2\] Inlet Pipe Assembly](#) to existing exhaust with supplied [\[1\] Hardware and Gasket](#).

For 2014 and up installation attach [\[4\] Extension Pipe](#) to existing exhaust with supplied [\[3\] Clamp](#).

STEP 4: For 2007.5-2013 attach [\[4\] Extension Pipe](#) to [\[2\] Inlet Pipe Assembly](#) with supplied [\[3\] Clamp](#).

STEP 5: Attach [\[8\] Over Axle Pipe Assembly](#) to [\[4\] Extension Pipe](#) and appropriate 2007-2019 long [\[6\] Hanger Clamp](#) or 2020 and up short [\[7\] Hanger Clamp](#) to existing isolators with supplied [\[5\] Clamp](#).

STEP 6: Attach [\[13\] Tail Pipe](#) to [\[8\] Over Axle Pipe Assembly](#) and appropriate 2007-2013 [\[10\] Hanger Clamp](#) with no hanger bend, 2014-2019 [\[11\] Hanger Clamp](#) short hanger with bend, or 2020 and up [\[12\] Hanger Clamp](#) long hanger with bend to existing isolators with supplied [\[9\] Clamp](#).

STEP 7: Ensure new exhaust is not contacting any portion of the underbody of the vehicle or drivetrain.

STEP 8: Tighten all clamps starting from rear of the vehicle. **(DO NOT EXCEED 30FT-LB WHEN TIGHTENING CLAMP AND CHECK ALL CLAMPS AFTER 50 MILES. RETIGHTEN IF NECESSARY)**

WARNING:

When working on, under, or around any vehicle exercise caution. Please allow the vehicle's exhaust system to cool before removal, as exhaust temperatures may cause severe burns. If working without a lift, always consult vehicle manual for correct lifting specifications. Always wear safety glasses and ensure a safe work area. Serious injury or death could occur if safety measures are not followed.



BRExhaust recommends
professional installation
for all products

Technical Support: 1-800-631-7271

BRExhaust — 1901 Corporate Ctr, Oceanside, CA 92056

BRExhaust™

A **MAGNAFLOW** GROUP COMPANY

INSTALLATION INSTRUCTIONS | PART NO. 106-0751

TABLE 1.

Vehicle Configuration	2014-2016	2017-2019	2020
Crew Cab/Long Bed	26.50"	16.25"	31.00"
Crew Cab/Standard Bed	13.25"	3.00"	4.50"
Double Cab/Long Bed	18.40"	8.15"	-
Double Cab/Standard Bed	4.50"	N/A	-

TABLE 2.

Item	Hanger	2007-2013	2014-2019	2020
3 5 9	4.00" Band Clamps	X	X	X
7	U-Bolt Hanger Short			X
6	U-Bolt Hanger Long	X	X	
10	Torca Hanger Clamp Rr No Bend	X		
11	Torca Hanger Clamp Rr Short w/Bend		X	
12	Torca Hanger Clamp Rr Long w/Bend			X

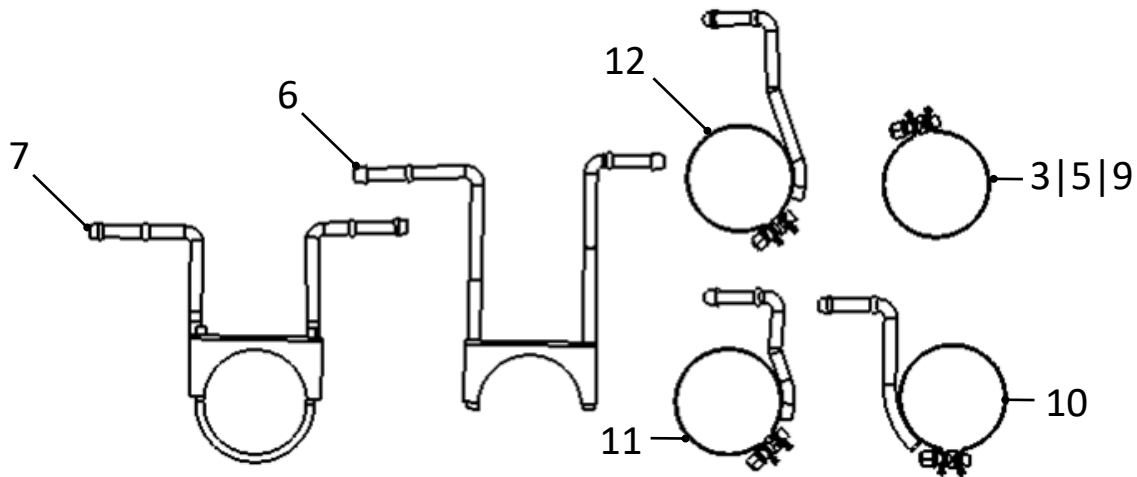

WARNING:

When working on, under, or around any vehicle exercise caution. Please allow the vehicle's exhaust system to cool before removal, as exhaust temperatures may cause severe burns. If working without a lift, always consult vehicle manual for correct lifting specifications. Always wear safety glasses and ensure a safe work area. Serious injury or death could occur if safety measures are not followed.



BRExhaust recommends professional installation for all products

Technical Support: 1-800-631-7271

BRExhaust — 1901 Corporate Ctr, Oceanside, CA 92056