

2008 - 2009 Chevrolet Cobalt SS 2.0L Turbo

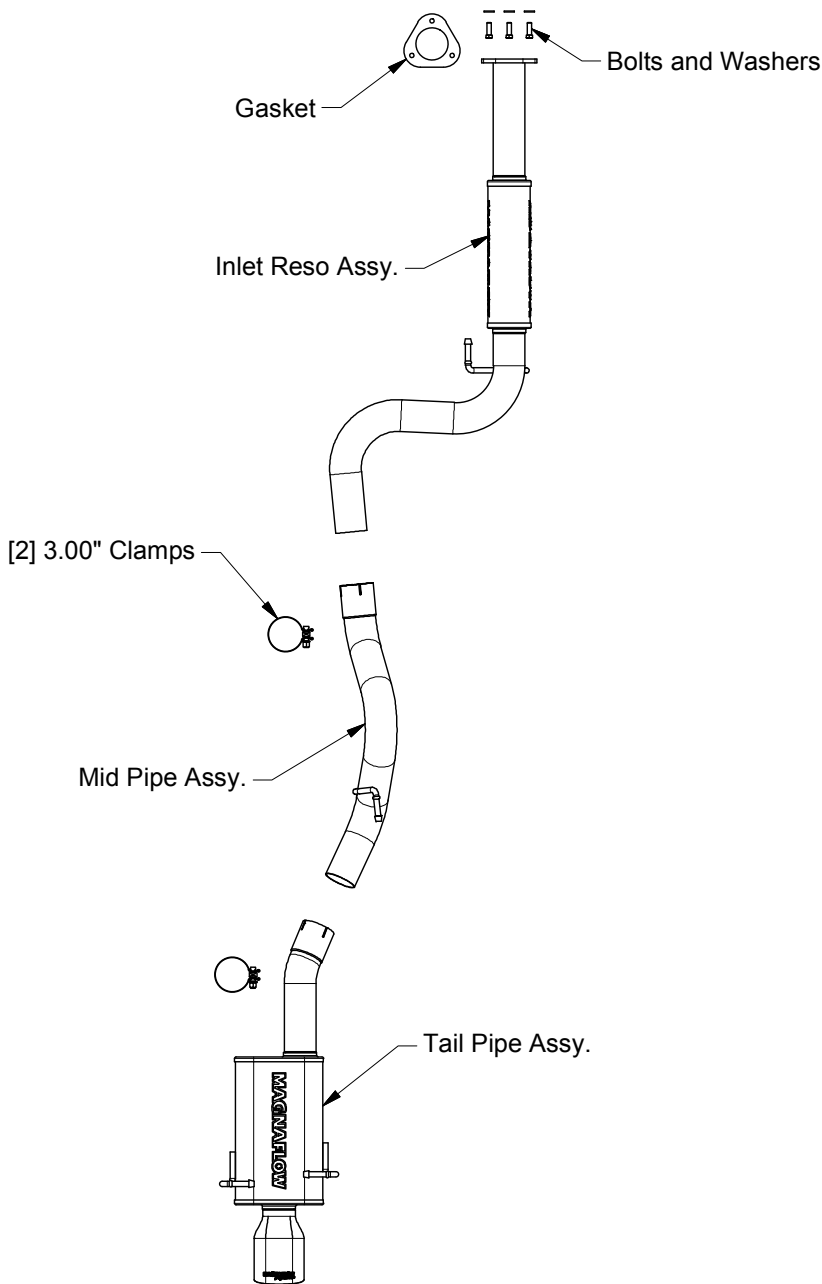

Warning: When working on, under, or around any vehicle exercise caution. Please allow the vehicle's exhaust system to cool before removal, as exhaust system temperatures may cause severe burns. If working without a lift, always consult vehicle manual for correct lifting specifications. Always wear safety glasses and ensure a safe work area. Serious injury or death could occur if safety measures are not followed.

Step 1: (Carefully read all instructions before installation) You will need to cut the OEM exhaust just behind the muffler to aid the removal process. Unbolt the 3-bolt inlet flange at the catalytic converter. Disengage all welded hangers from the rubber insulators. The OEM exhaust may now be removed.

Step 2: Begin installation of your new MAGNAFLOW exhaust system by loosely fastening the Inlet Reso Assy to the catalytic converter outlet using the supplied gasket, bolts and washers. Locate the welded hanger to the rubber insulator. Slip the inlet of the Mid-Pipe Assy over the Inlet Reso Assy outlet. Loosely secure with the supplied 3.00" Clamp. Attach the Tail Pipe Assembly in a similar fashion locating all welded hangers to the rubber insulators.

Step 3: With all components mounted loosely, adjust the system for overall aesthetics and clearance of frame & bodywork. (MAGNAFLOW recommends at least 1/2" of clearance between the exhaust system and any body panels to prevent heat-related body damage or fire.)

Step 4: Once a final position has been chosen for the new system, evenly tighten all fasteners from front to rear. The supplied band clamps must be VERY tight to properly align the pipes and prevent leaks (Approximately 40ft-lbs). U-bolt clamps should be tightened to approximately 30-35ft-lbs. Inspect all fasteners after 25-50 miles of operation and retighten if necessary.

**** Magnaflow Performance Exhaust recommends professional installation on all their products**