



INSTALLATION INSTRUCTIONS



GM 2500/3500 6.6L

PART NO. 17074

BILL OF MATERIALS:

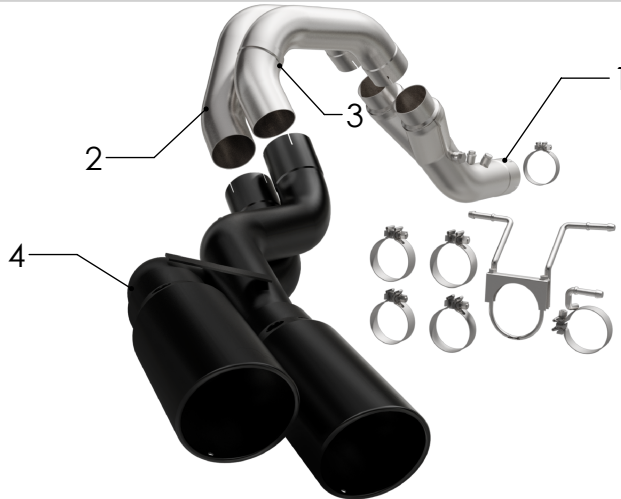

- 1. Y-PIPE ASSY
- 2. OVER AXLE PIPE D/S
- 3. OVER AXLE PIPE P/S
- 4. TAIL PIPE ASSY

SHOP SUPPLIES:

SPRAY LUBRICANT

To ease removal of existing exhaust components (especially on older vehicles) spray penetrating lubricant on all fasteners and hangers/insulators that will be loosened or removed and let soak before disassembly.

HARDWARE KIT:

- 1.[4] 3.50" Torca Clamp
- 2.[2] 4.00" Torca Clamp
- 3.[1] U-Bolt Hanger Clamp
- 4.[1] Torca Hanger Clamp
- 5.[1] Hex Plug M16
- 6.[1] Hex Plug M14
- 7.[1] Hex Plug M20
- 8.[2] Hex Nut 3/8



WEAR SAFETY GLASSES



READ INSTRUCTIONS THOROUGHLY BEFORE INSTALLING PRODUCT



MINIMUM REQUIRED TOOLS:



SAWZALL, SIMILAR CUTTING TOOL



13mm, 15 mm



Hanger Tool (Or Pry Bar)

MAGNAFLOW RECOMMENDS PROFESSIONAL INSTALLATION ON ALL THEIR PRODUCTS



WARNING: When working on, under, or around any vehicle exercise caution. Please allow the vehicle's exhaust system to cool before removal, as exhaust system temperatures may cause severe burns. If working without a lift always consult vehicle manual for correct lifting specifications. Always wear safety glasses and ensure a safe work area. Serious injury or death could occur if safety measures are not followed.

ATTENTION: Always install any supplied band or U-bolt clamps to the proper torque specifications of 40-45 ft-lb for band clamps and 30-35 ft-lb for U-bolt clamps. Over tightening will result in the clamps breaking and will NOT be warranted by MagnaFlow.

MAGNAFLOW: 1901 Corporate Centre Dr - Oceanside, CA 92056 | 1(800)990-0905
 Technical Support: 1(800) 959-9226 | Email: moreinfo@magnaflow.com

INSTALLATION INSTRUCTIONS

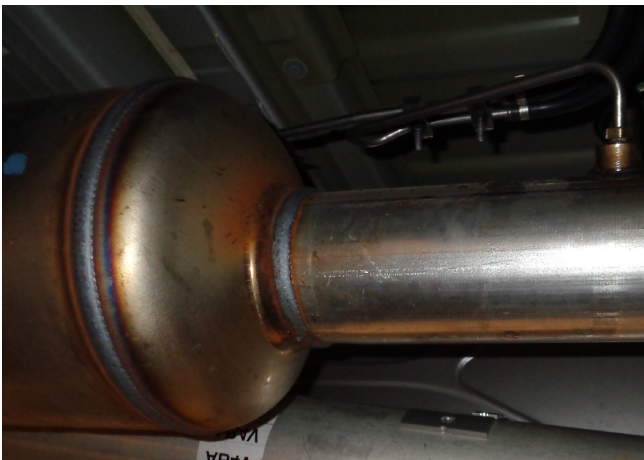
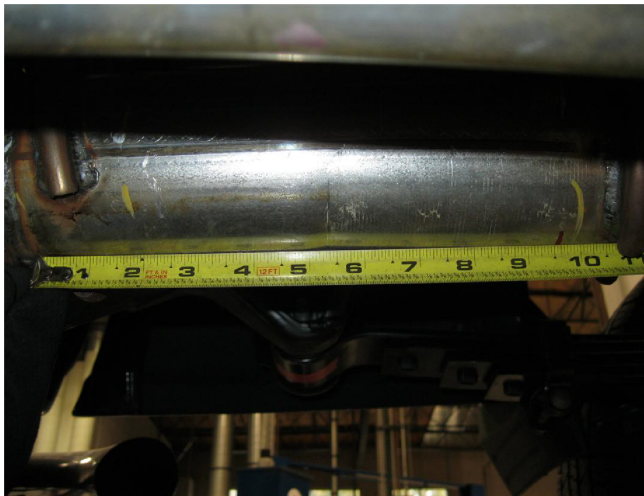

Step 1. To begin the removal of the OEM system check to see if it has sensor(s) connected to it, if so, remove the sensor(s) and hang it/them out of the way. Next, you will need to cut the exhaust pipe behind the DPF measuring from the rear weld junction to the rear of the vehicle (**See sheet 3 of 3 for cut table**). Once cut, you can then disengage the welded hangers from the rubber insulators, working rearward finish removing the system. Do not damage or discard the rubber insulators, as they will be reused to mount the new system.

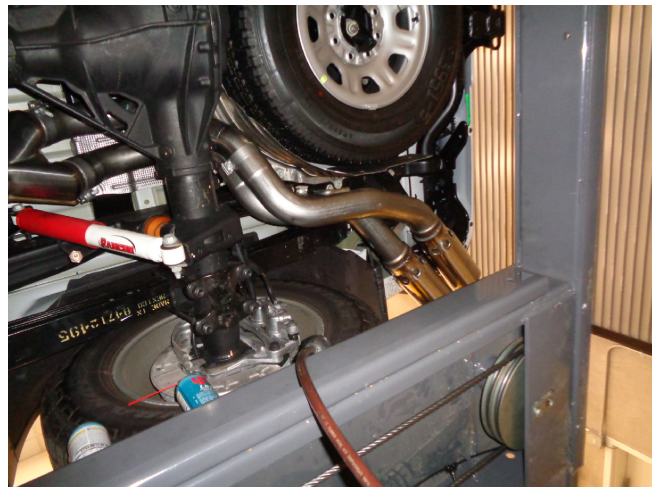

Step 2. Begin installation of the Magnaflow system by first clamping the Y-Pipe Assembly inlet to the newly cut outlet of the DPF using the supplied 4.00" clamp. If your vehicle has any sensor(s) re-install at the appropriate locations. Any boss that doesn't get a sensor installed into it must be closed off with a provided screw in plug. Next attach the two Over Axle Pipes to the Y-Pipe Assembly using the supplied 3.50" clamps and fitting the hangers in the rubber insulators (leave all clamps loose for final adjustment of the complete system).

INSTALLATION INSTRUCTIONS

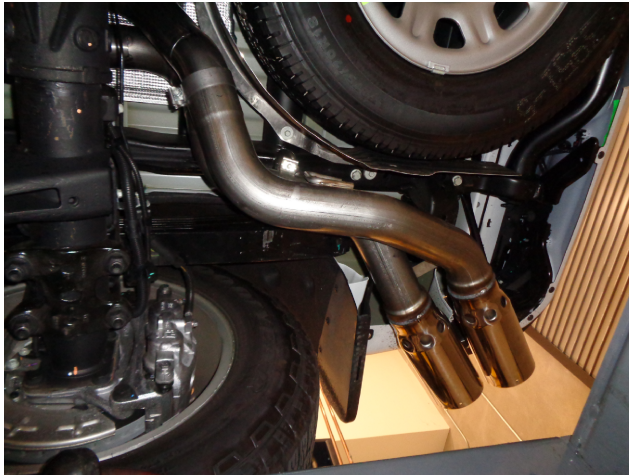

Step 3. Complete the installation by sliding the specified Rear Hanger Clamp Assy onto the Tailpipe Assy and attaching the Tailpipe Assy to the Over Axle Pipe. Engage the hangers into OE rubber insulators.



Step 4. Once a final position has been chosen for the new exhaust system, evenly tighten all clamps and fasteners, from front to rear, using the torque specifications on page one of the instructions. Inspect all fasteners after 25-50 miles of operation and re-tighten if necessary.

Cut Table	
Vehicle Configuration	Cut Length
Crew Cab/Long Bed	29.00"
Crew Cab/Standard Bed	3.50"
Double Cab/Long Bed	N/A
Double Cab/Standard Bed	N/A