



INSTALLATION INSTRUCTIONS



C7 CHEVROLET CORVETTE 6.2L

PART NO. 19381

BILL OF MATERIALS:

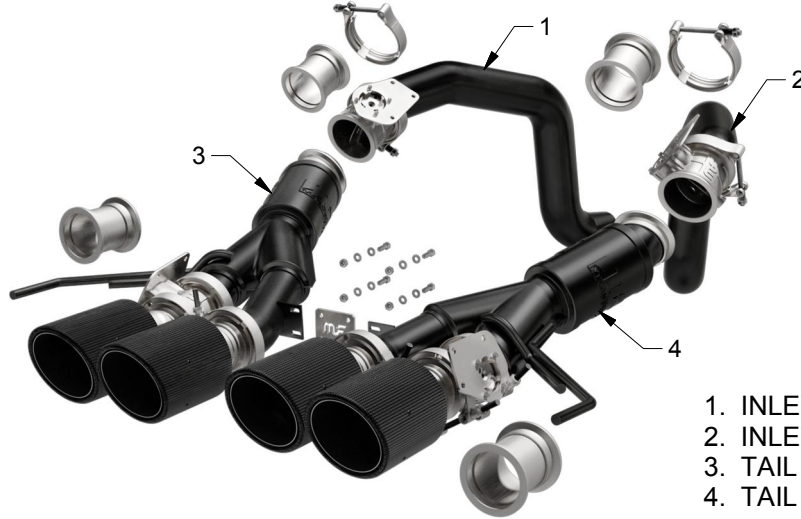

- 1. INLET PIPE ASSEMBLY D/S
- 2. INLET PIPE ASSEMBLY P/S
- 3. TAIL PIPE ASSEMBLY D/S
- 4. TAIL PIPE ASSEMBLY P/S



WEAR SAFETY GLASSES



READ INSTRUCTIONS THOROUGHLY BEFORE INSTALLING PRODUCT

SHOP SUPPLIES:



SPRAY LUBRICANT

To ease removal of existing exhaust components (especially on older vehicles) spray penetrating lubricant on all fasteners and hangers/insulators that will be loosened or removed and let soak before disassembly.

HARDWARE KIT:

- 1. [2] 3.00" Clamps
- 2. [4] 1/4" Hex Nuts
- 3. [4] 1/4"x.75" Hex Bolts
- 4. [4] 1/4" Lock Washers
- 5. [8] 1/4" Flat Washers
- 6. [2] 2.50 Valve delete
- 7. [2] 3.00 Valve delete

MINIMUM REQUIRED TOOLS:



18mm, 15mm, 13mm, 10mm, 8mm, 7mm, #20 Torx



Hanger Tool (Or Pry Bar)

MAGNAFLOW RECOMMENDS PROFESSIONAL INSTALLATION ON ALL THEIR PRODUCTS



WARNING: When working on, under, or around any vehicle exercise caution. Please allow the vehicle's exhaust system to cool before removal, as exhaust system temperatures may cause severe burns. If working without a lift always consult vehicle manual for correct lifting specifications. Always wear safety glasses and ensure a safe work area. Serious injury or death could occur if safety measures are not followed.

ATTENTION: Always install any supplied band or U-bolt clamps to the proper torque specifications of 40-45 ft-lbs for band clamps and 30-35 ft-lbs for U-bolt clamps. Over tightening will result in the clamp breaking and will NOT be warranted by MagnaFlow.

INSTALLATION INSTRUCTIONS



Step 1. To remove the OEM exhaust system you will first need to remove the rear valence. To do so you will need to remove The two 10mm bolts behind each reflector, the two 10mm bolts behind the license plate and two more 10mm bolts just underneath the license plate.



Step 2. Then you will need to remove the five 7mm bolts on both sides of the valence underside. Remove two 10mm bolts above the exhaust tips. The valence is fastened from the backside with molded-in plastic tabs. Release the six tabs from the valence by gently pulling each tab from the valence.



Step 3. Next, remove the six 10mm bolts from the valence top. Carefully release the tabs on the top of the valence. The valence may now be removed.

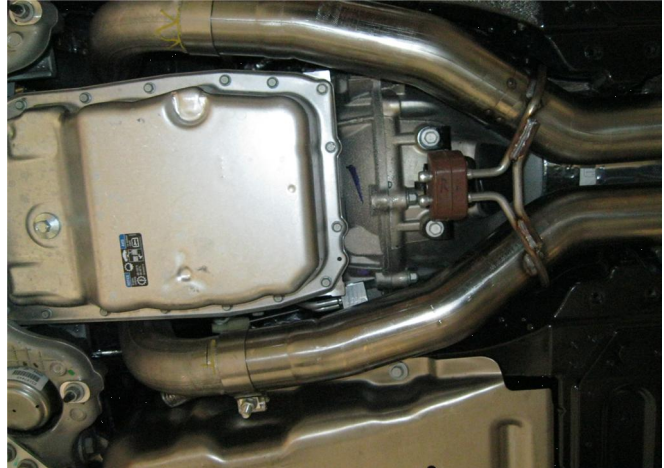

Step 4. On vehicles with automatic transmission you will need to disconnect the shift linkage located on the drivers side of the transmission.



Step 5. Unbolt both hanger brackets located either side of the muffler assemblies. Unclip the plug connecting the valve motor assemblies to the inlet pipes. Disconnect the wiring harness on both sides of the tail pipe assemblies.

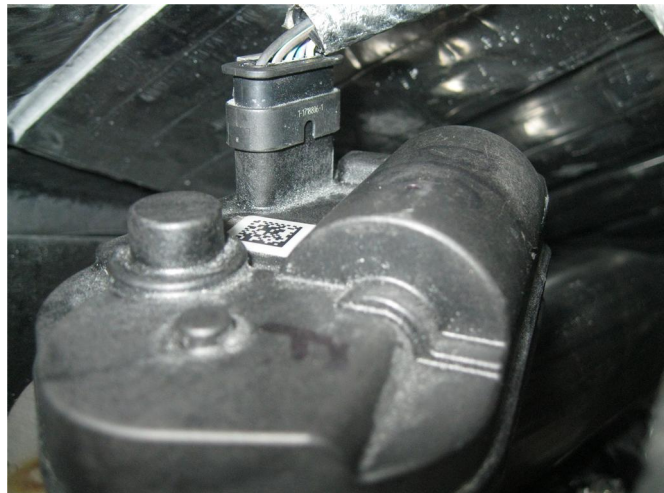

INSTALLATION INSTRUCTIONS

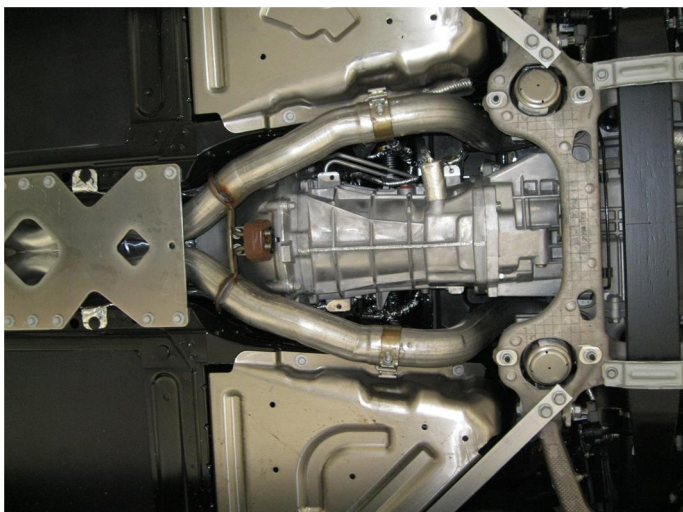

Step 6. Loosen both OEM clamps just rearward of the stock X-Pipe assembly. The OEM exhaust system may now be removed.

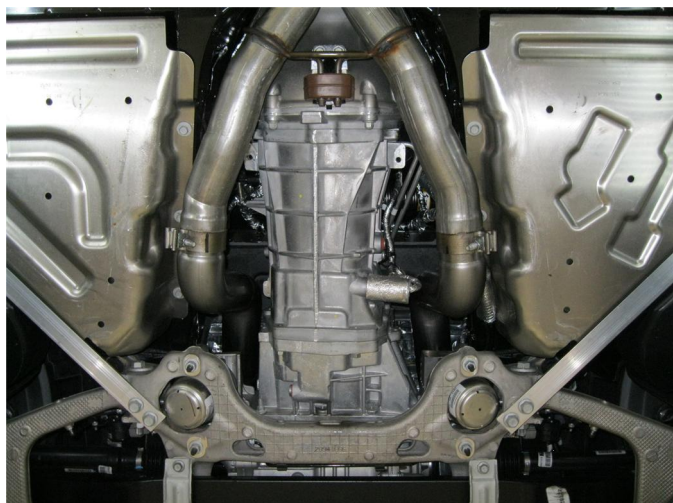

Step 7. Begin installation of your new MAGNAFLOW exhaust system by attaching each valve motor to the new system using the OEM fasteners. Install both drivers side and passengers side Inlet Pipe Assemblies to the OEM X-Pipe. Loosely secure using the OEM clamps.



Step 8. Locate both OEM hanger brackets to each Tail Pipe Assembly. Next, loosely attach both assemblies to the Inlet Pipe Assembly outlets using the supplied 3.00" clamps. Using the supplied nuts, bolts and washers connect the two hanger brackets that will link both sides together. Reconnect each wiring harness connector to the valve motors. Reinstall the rear valence in the reverse order of the removal process.



Step 9. Once a final position has been chosen for the new exhaust system, evenly tighten all clamps from front to rear using the torque specifications on page one of the instructions. Inspect all fasteners after 25-50 miles of operation and re-tighten if necessary.